

RIPARAZIONE DEI DANNI POST SISMA  
DEL 20-29 MAGGIO 2012

INTERVENTI DI RIPARAZIONE E RAFFORZAMENTO LOCALE

**Teatro Facchini**  
Piazza del Popolo n° 7  
Medolla



PROGETTO ESECUTIVO

**Committente:** COMUNE DI MEDOLLA  
Viale Rimebranze n° 19  
41036 Medolla (MO)

**Progettista Architettonico  
Direttore dei Lavori** ARCH. MARINA SPEZIALI  
Via San Matteo n° 4 - 41036 - Medolla (MO)  
Tel. - Fax : 0535/27774

**Progettista Strutturale  
Direttore dei Lavori strutturali** ING. MARCO BRUINI  
Via DALTON n° 48 - 41122 - Modena  
Tel. - Fax : 059/4822204

Tav. n°

2

Oggetto :

RILIEVO DEL QUADRO FESSURATIVO

**Scala :**

1:100

**Pratica :**



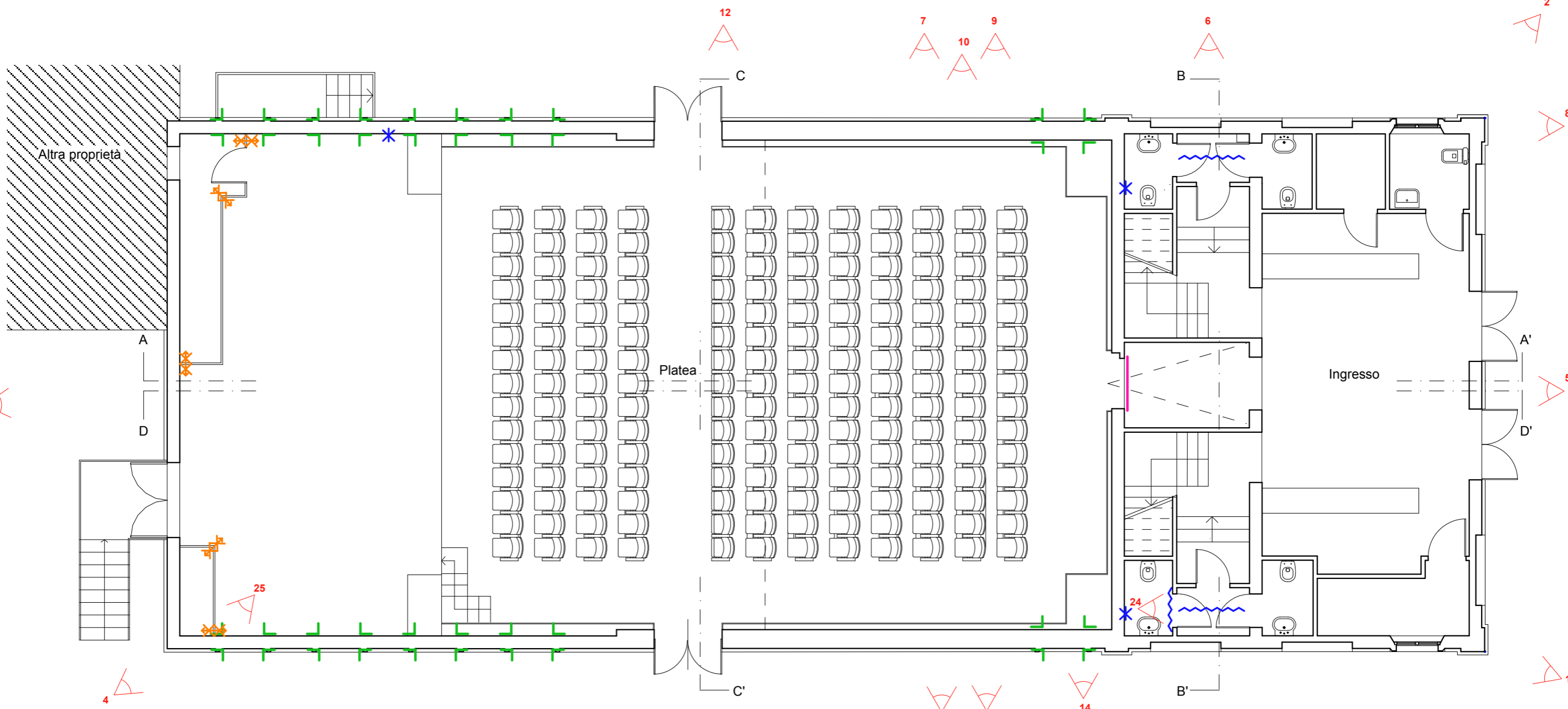



BMF02/13

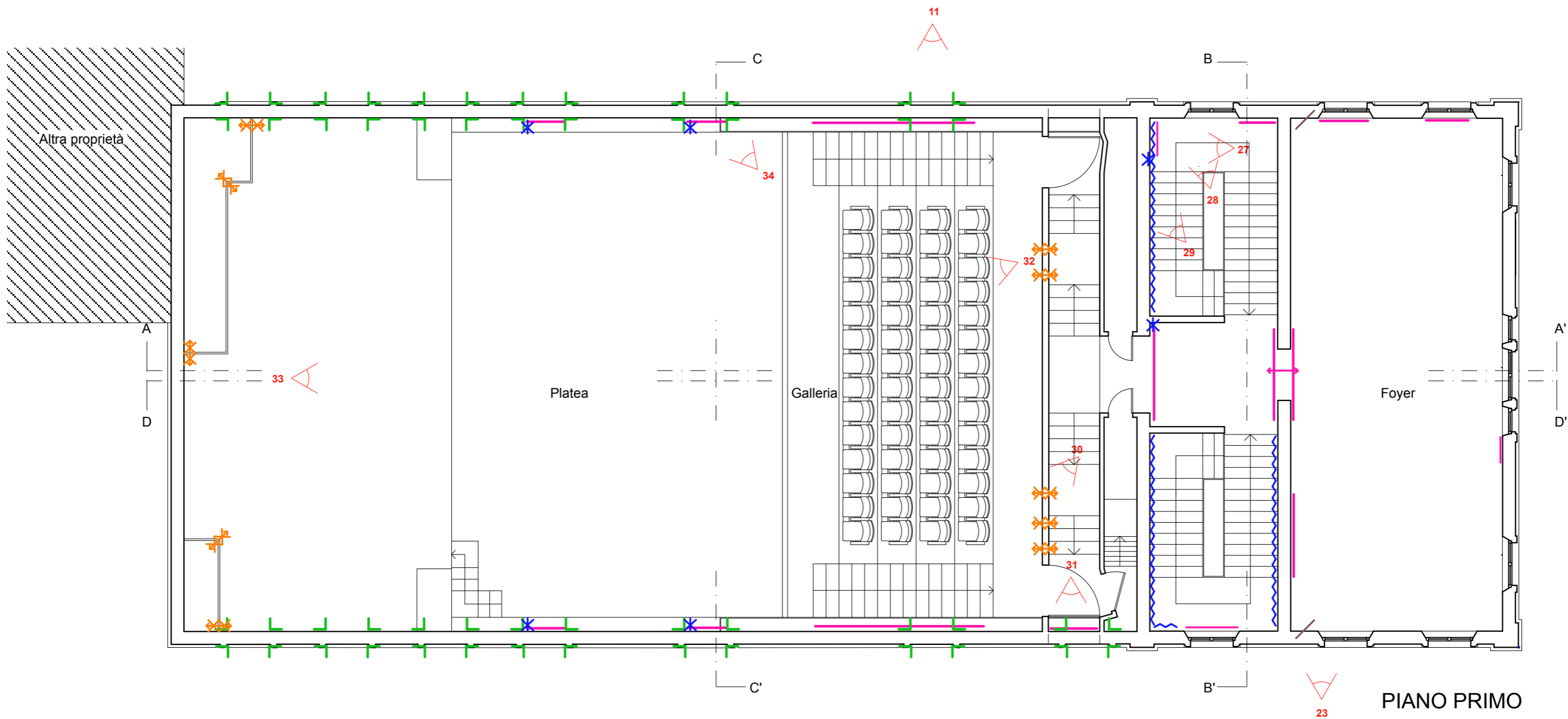

PIANO TERRA







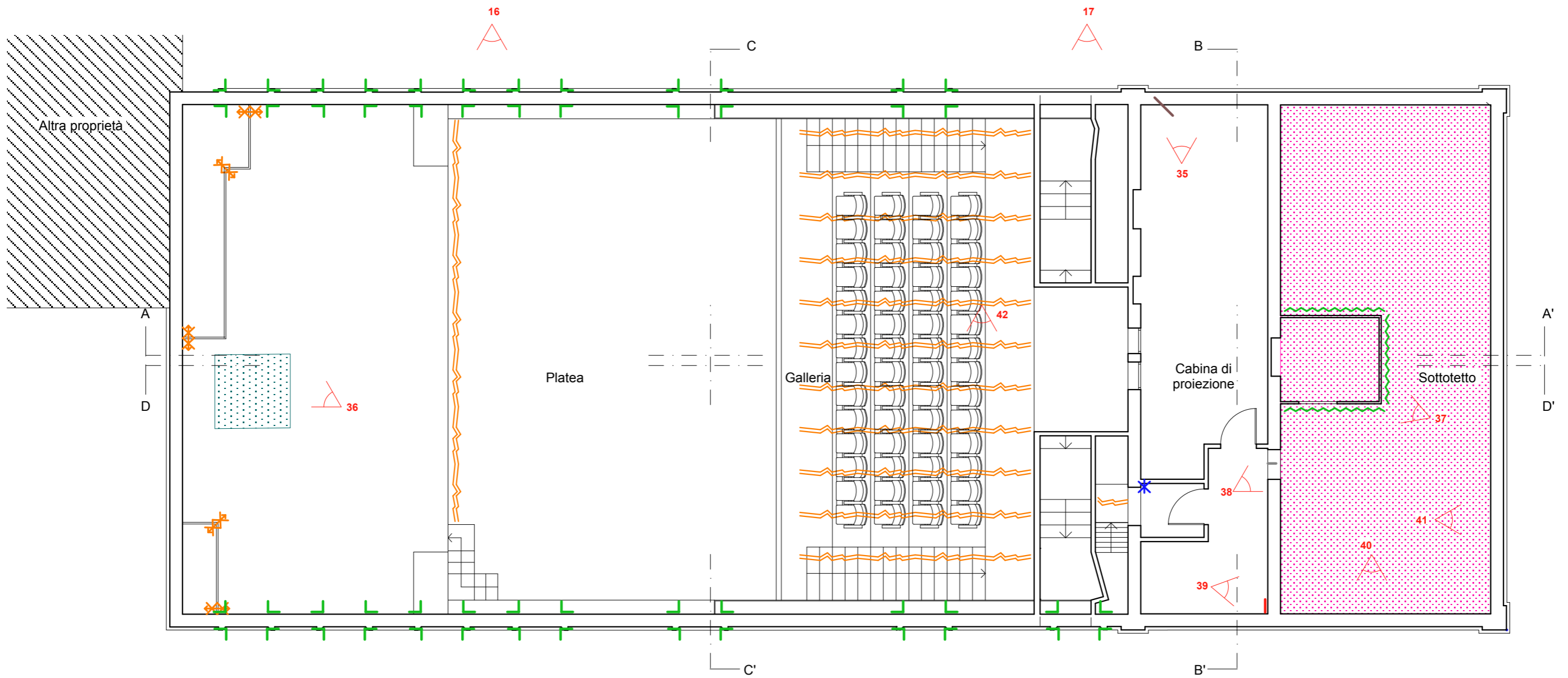

TIPOLOGIA DI DANNO			
*	Lesione verticale non passante	~~~~~	Lesione nei voltini
✕	Lesioni passanti nelle pareti in cartongesso	—	Lesione orizzontale
+	Apertura tamponata		



TIPOLOGIA DI DANNO					
	Lesione verticale non passante		Lesione nei voltini		Lesione inclinata
	Lesioni passanti nelle pareti in cartongesso		Lesione orizzontale		
	Apertura tamponata		Lesione orizzontale passante		

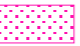

PIANO SECONDO

TIPOLOGIA DI DANNO					
	Lesione verticale non passante		Distacco intonaco		Lesione inclinata
	Crollo controsoffitto in cartongesso		Crollo parziale muratura		Lesione nell'architrave
	Lesioni passanti nelle pareti in cartongesso		Diffusa rottura e distacco di tavelloni in laterizio		Lesioni passanti nel controsoffitto in cartongesso

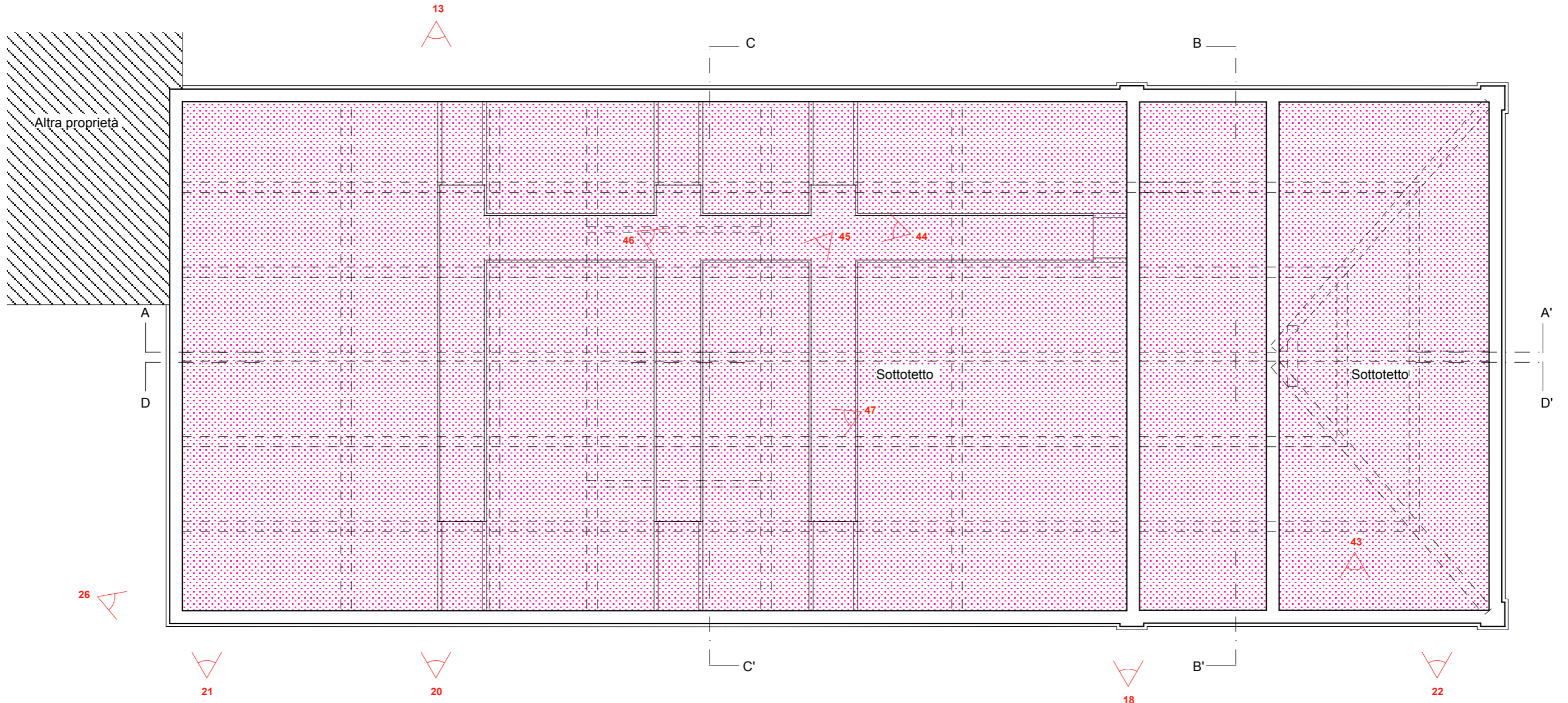

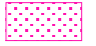

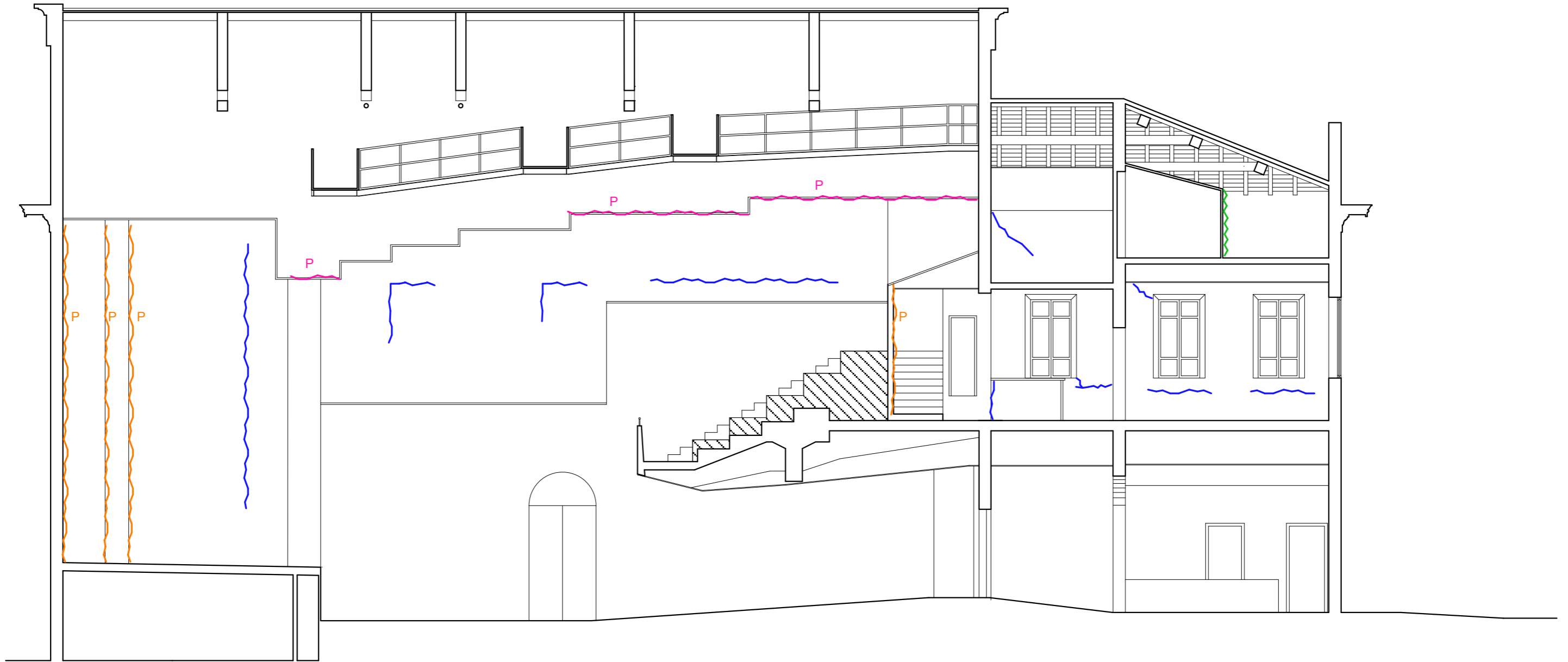

TIPOLOGIA DI DANNO	
	Diffusa rottura e distacco di tavelloni in laterizio

SOTTOTETTO



**TIPOLOGIA DI DANNO**

	Lesione non passante		Crollo parziale muratura
	Lesioni passanti nelle pareti in cartongesso		Lesioni passanti nel controsoffitto in cartongesso

SEZIONE A-A'

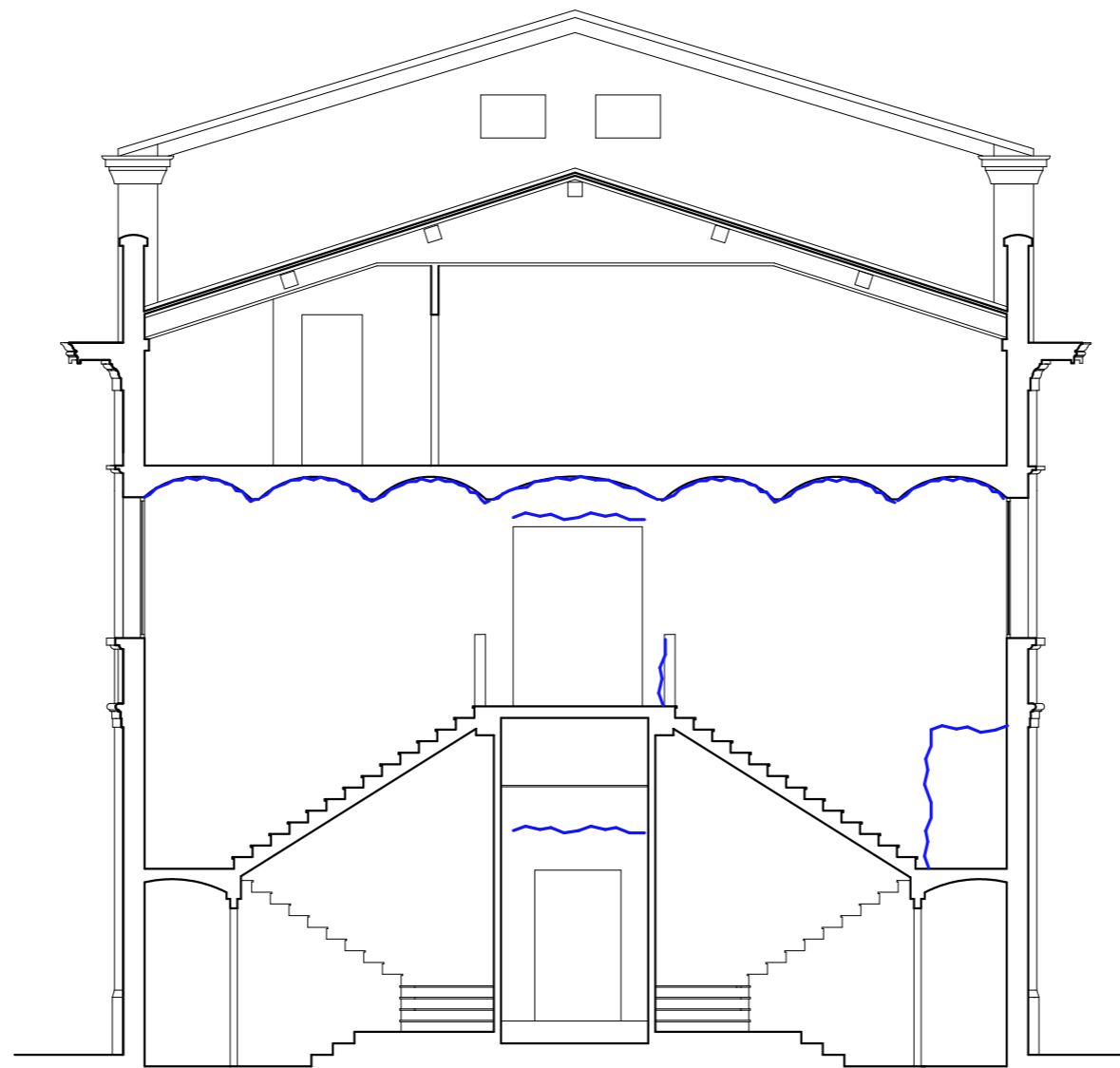

SEZIONE B-B'

TIPOLOGIA DI DANNO	
	Lesione non passante

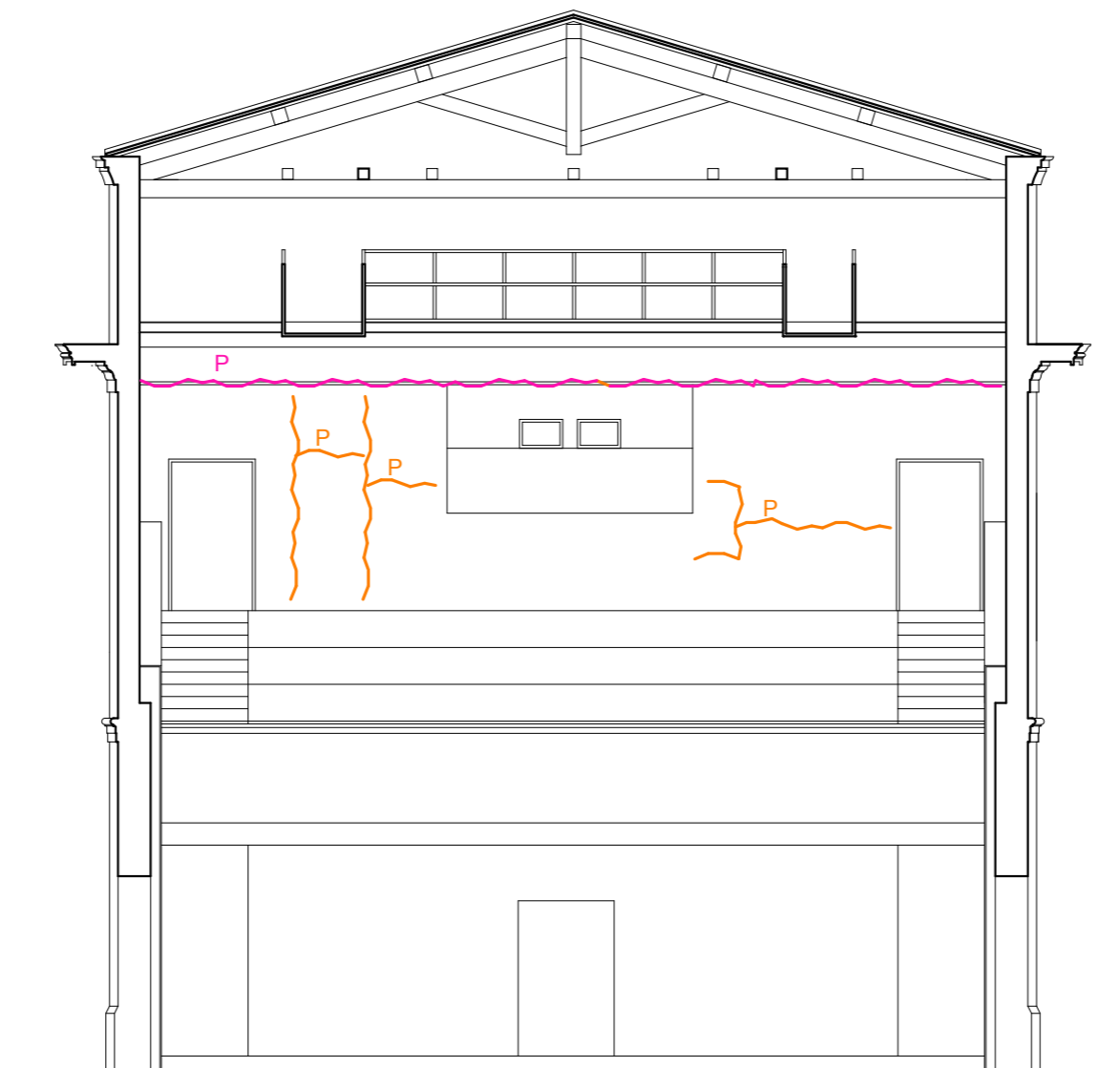



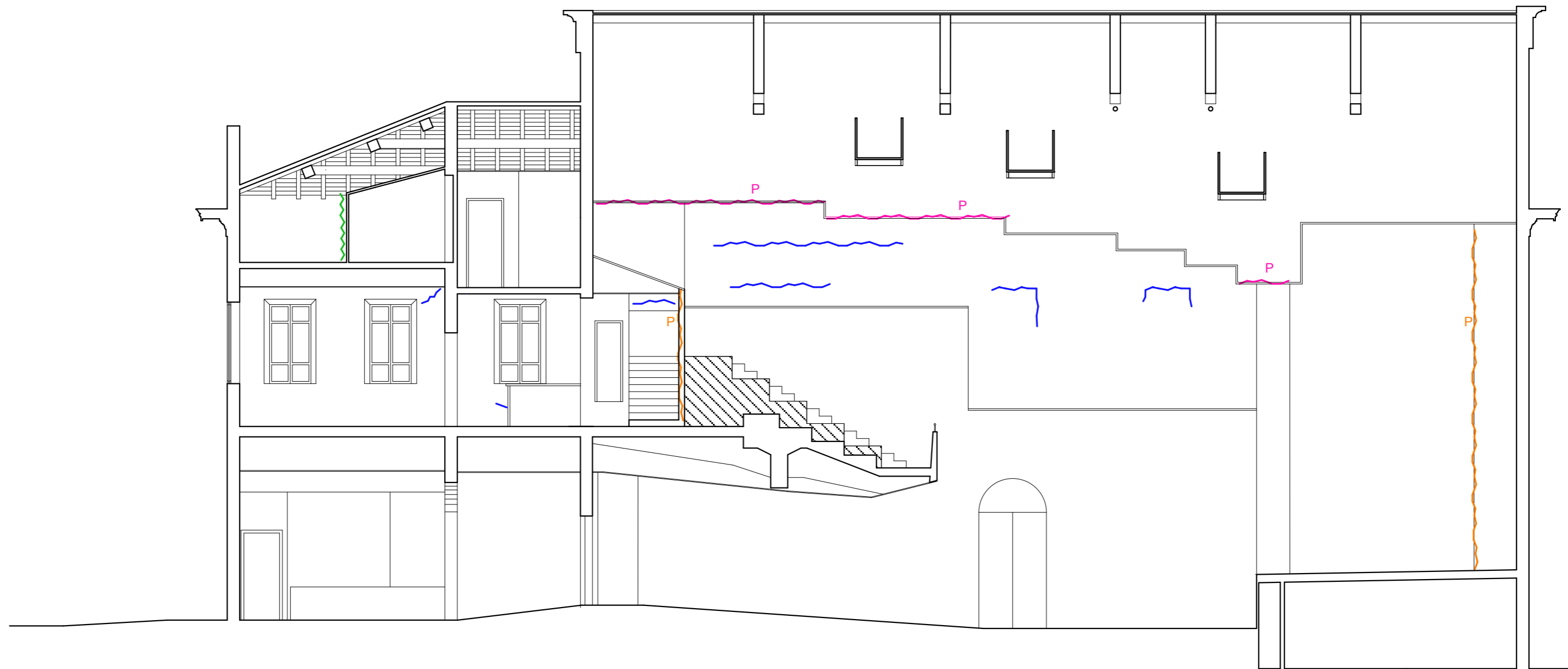

SEZIONE C-C'

TIPOLOGIA DI DANNO	
	Lesioni passanti nelle pareti in cartongesso
	Lesioni passanti nel controsoffitto in cartongesso







**TIPOLOGIA DI DANNO**

	Lesione non passante		Crollo parziale muratura
	Lesioni passanti nelle pareti in cartongesso		Lesioni passanti nel controsoffitto in cartongesso

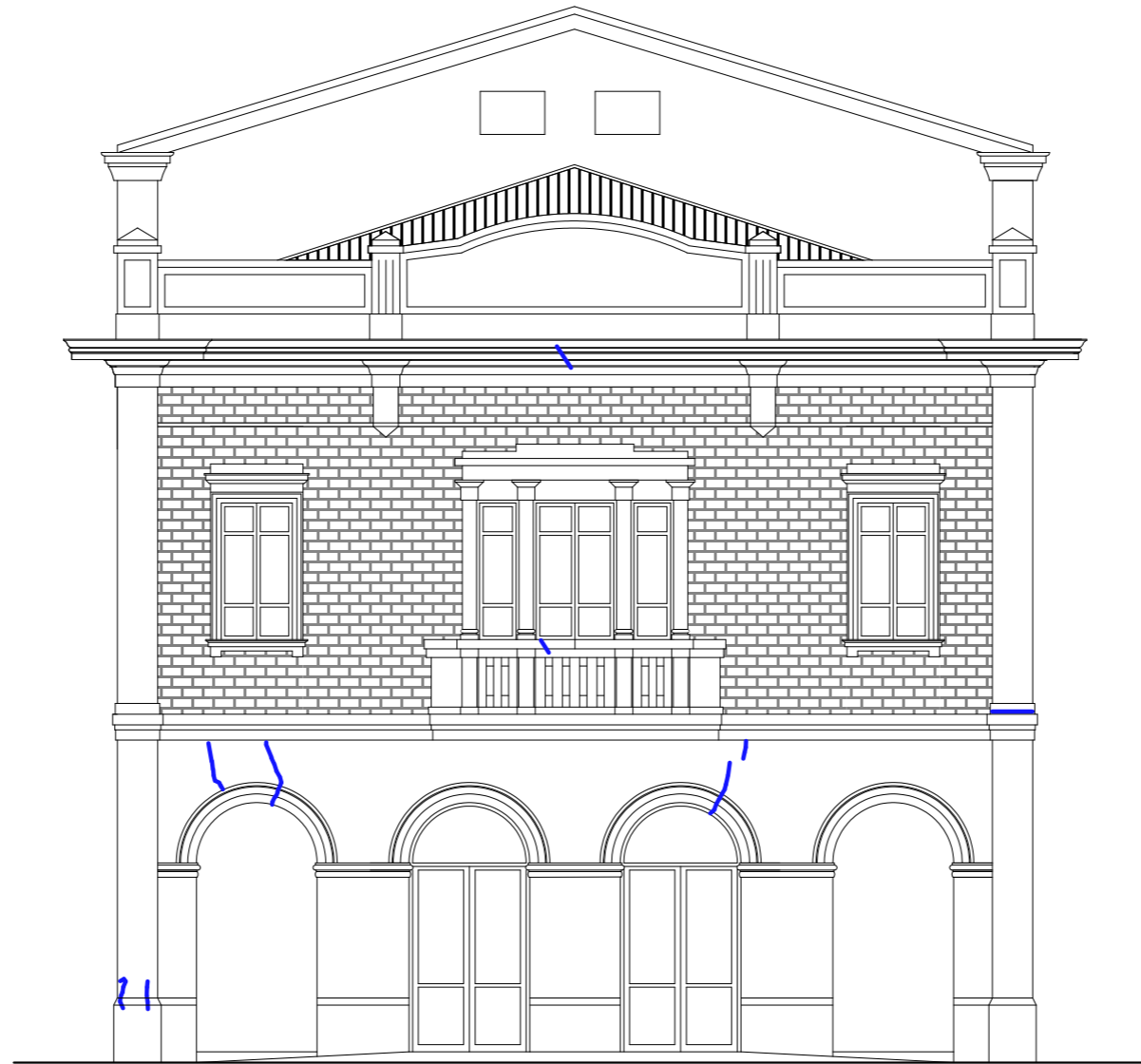
SEZIONE D-D'



PROSPETTO EST

TIPOLOGIA DI DANNO	
	Lesione non passante

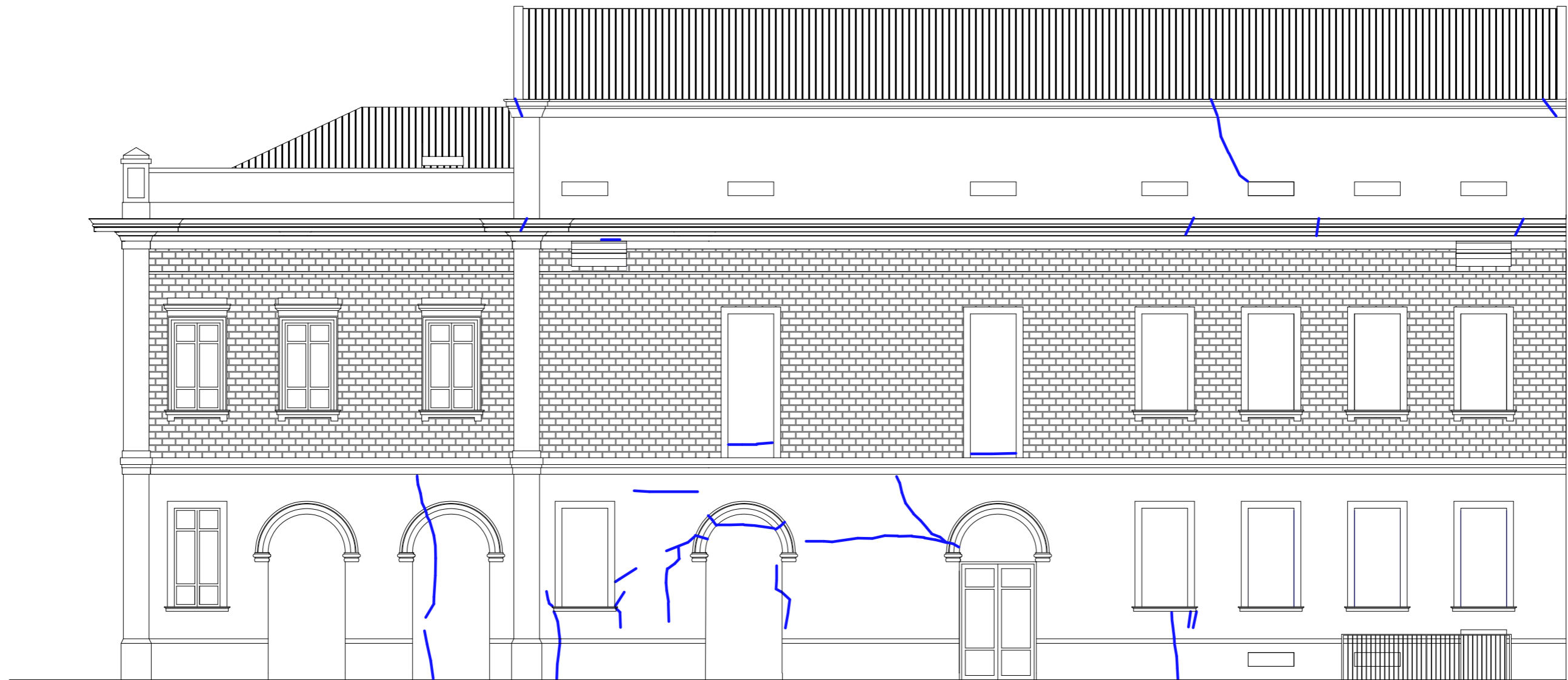

PROSPETTO NORD

TIPOLOGIA DI DANNO	
	Lesione non passante

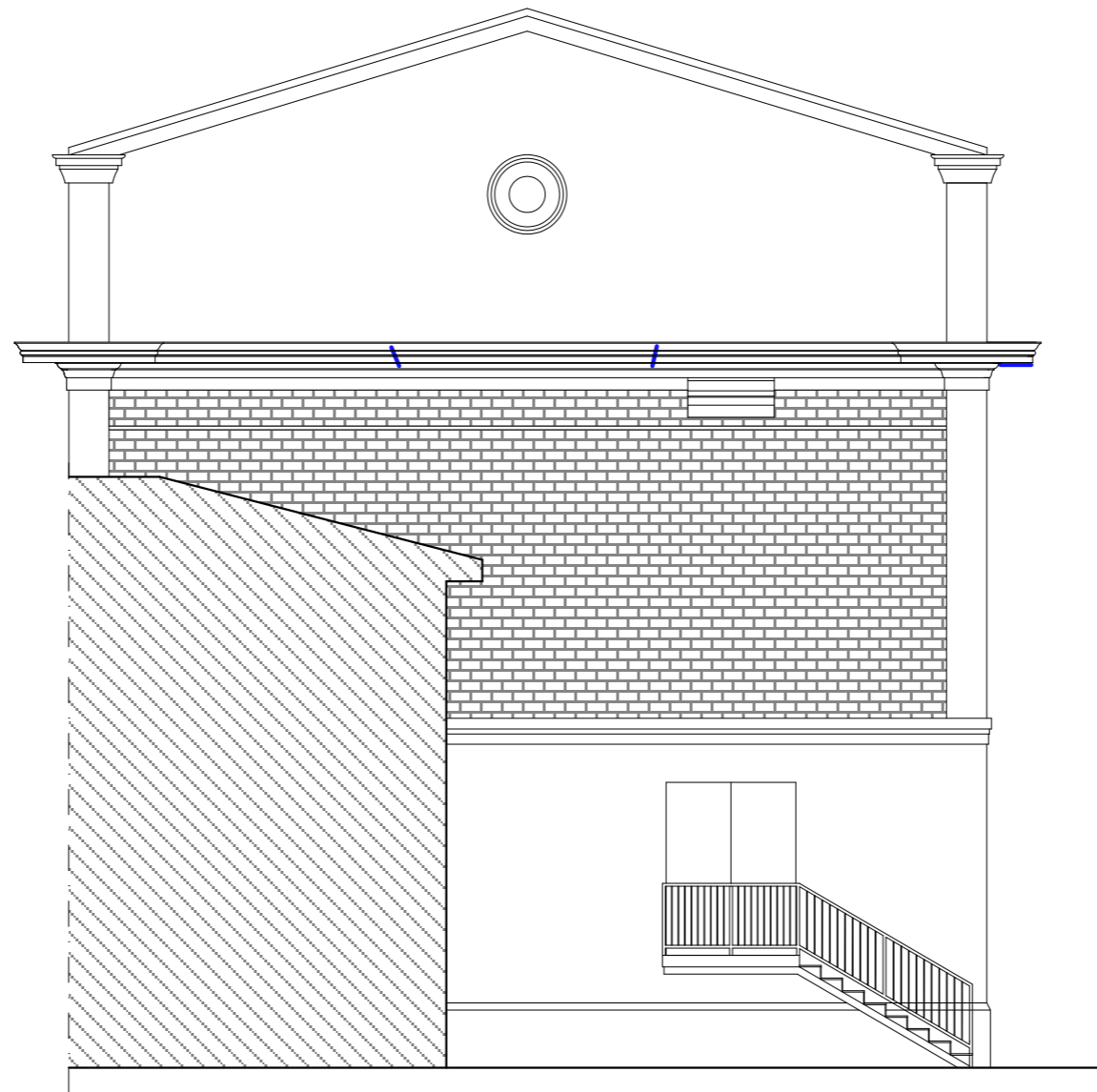

PROSPETTO OVEST

TIPOLOGIA DI DANNO	
	Lesione non passante

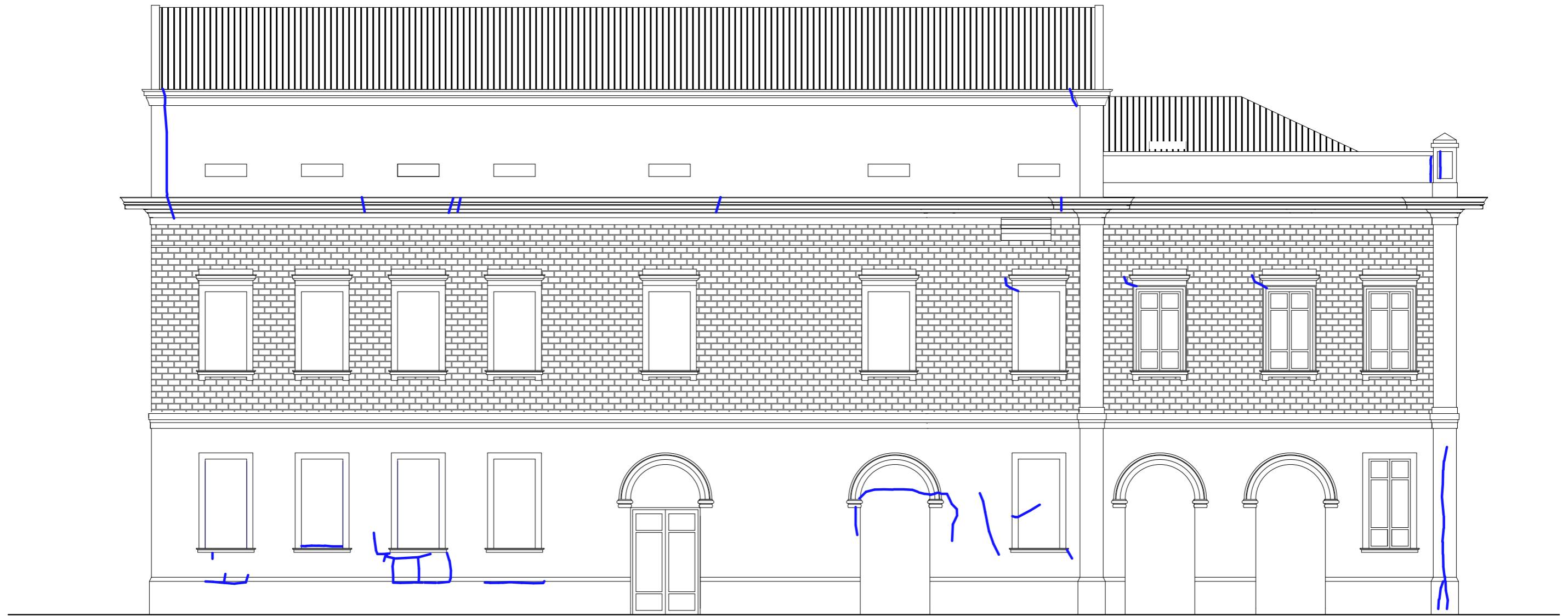

PROSPETTO SUD

TIPOLOGIA DI DANNO	
	Lesione non passante





